

Architectural Design Square (ADS) Medium Base H.I.D.

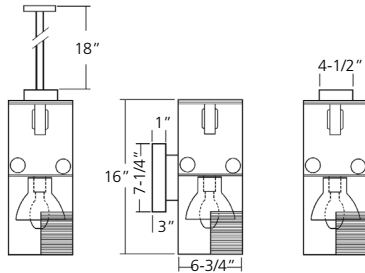

Lamp included 

H.I.D.



Architectural Design Specification

Architectural Design Square series offers an excellent selection of accent luminaires which will compliment and also maintain the proper perspective of any type of building construction. Available in 35 to 100 watt medium base high pressure sodium lamp, or 50 to 100 watt medium base metal halide lamp. Available with (specify) 120, 208, 240, 277 volt, or 4MT (120,208,240,277V) 60Hz ballast. Luminaire shall be completely pre-wired for ease of installation.

Basic Product Description

Heavy duty one-piece extruded aluminum housing is finished in an all weather polyester powder coating. Standard colors include: bronze, black, white and silver (optional colors available). Luminaire is available for pendant, ceiling, or for wall mounting applications. Pendant assembly supplied with 18" stem (optional lengths available). Socket housing contains a high-quality medium base porcelain socket with a brass nickel plated screw shell. Mounting hardware is heavy duty and sized to safety support and compliment the overall appearance of each assembly. To assure safe delivery, luminaire and mounting hardware are shipped in one carton. Luminaire is U.L. listed for damp location (wall mounted luminaire with clear or prismatic glass lens shall be suitable for wet locations).

Ballast Characteristics

The ADS shall contain a U.L. recognized Normal Power Factor ballast or a High Power Factor ballast. Will start and operate lamp down to -20°F (-30°C) for metal halide and -40°F (-40°C) for high pressure sodium.

Reflector Assembly

Spun diffuse aluminum reflector is standard.

Suggested Applications

Accent illumination of building facades, shopping centers, malls, hotels, condominiums, office complexes, entrances; interior or exterior.

ADS-TR-Tamper Resistant Hardware Kit.
Spanner head screws and bit. (order separately)

Ordering Example						
Unit	Wattage	Mounting	Lamp Style	Voltage	Ballast Style	Downlight Trim
ADS	1	58	H	120	H	CO
Architectural Design Square	35 50 0 - 70 1 - 100	57- Pendant Mount 58 - Ceiling Mount 59 - Wall Mount 57S - Swivel Mount: 20° swing from vertical	H - Metal Halide LS - High Pressure Sodium	120 208 240 277 4MT- (120, 208, 240, 277V)	N - Normal Power Factor H - High Power Factor	OD - Open Down Light BB - Black Baffle FL - Clear Glass Lens CO - Prismatic Glass Lens
					Finish	
					BK	
					BK -	Black
					BZ -	Bronze
					SL -	Silver
					WH -	White
					(optional colors available)	
CSA Certification - consult factory.						

Architectural Design Square (ADS) Medium Base H.I.D.

Photometrics

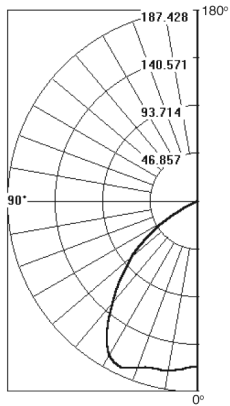

ZONAL LUMEN SUMMARY			
ZONE	LUMENS	%LAMP	%FIXT
0-30	148.0	14.8	35.5
0-40	252.0	25.2	60.5
0-60	401.0	40.1	96.4
0-90	416.0	41.6	100.0
90-180	0.0	0.0	0.0
0-180	416.0	41.6	100.0

COEFFICIENTS OF UTILIZATION - ZONAL CAVITY METHOD

	80				70				50				30				10				0
	70	50	30	10	70	50	30	10	50	30	10	50	30	10	50	30	10	50	30	10	0
0	49	49	49	49	48	48	48	48	46	46	46	44	44	44	42	42	42	42	42	42	42
1	46	45	44	42	45	44	43	42	42	41	40	41	40	39	39	39	38	37	37	36	37
2	43	40	38	36	42	40	38	36	38	36	35	37	35	34	36	35	34	36	35	34	33
3	40	36	33	31	39	36	33	31	34	32	30	33	32	30	32	31	29	29	28	26	29
4	37	33	30	27	36	32	29	27	31	29	27	30	28	26	29	28	26	25	24	22	25
5	34	29	26	24	33	29	26	24	28	26	23	27	25	23	27	25	23	22	21	20	22
6	32	29	23	21	31	26	23	21	26	23	21	25	23	21	24	22	20	20	19	18	20
7	29	24	21	19	29	24	21	19	23	21	19	23	20	18	22	20	18	18	17	16	18
8	27	22	19	17	27	22	19	17	21	19	17	21	18	17	21	18	17	16	15	14	16
9	26	20	17	15	25	20	17	15	19	17	15	19	17	15	19	17	15	14	13	12	14
10	24	19	16	14	24	19	16	14	18	16	14	18	15	14	18	15	14	13	12	11	13

Catalog Number: ADS-158H-120H-BB
Lamp: Phosphor Coated ED-17 Metal Halide

Reflector: Fabricated metal housing, spun diffused aluminum, black painted fabricated grooved lower baffle

Lumens: Per 1,000 lamp lumens

Efficiency: 41.6%

CIE Type: Direct

Luminaire Spacing Criteria: 1.4

Candela & Lumen values are based on 1,000 lamp lumens. For other lamp lumen ratings, multiply candela and lumen values by the number: Lumens divided by 1,000.

Per 1,000 Lamp Lumens

DEG	CANDELA	LUMENS
0	163.0	
5	165.0	16.0
15	170.0	49.0
25	180.0	83.0
35	156.0	104.0
45	107.0	90.0
55	60.0	59.0
65	5.0	14.0
75	0.9	0.6
85	0.3	0.3
90	0.0	

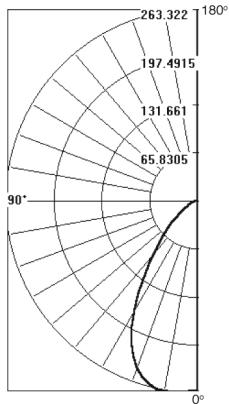

ZONAL LUMEN SUMMARY			
ZONE	LUMENS	%LAMP	%FIXT
0-30	194.0	19.4	52.0
0-40	273.0	27.3	73.4
0-60	349.0	34.9	93.8
0-90	372.0	37.2	100.0
90-180	0.0	0.0	0.0
0-180	372.0	37.2	100.0

COEFFICIENTS OF UTILIZATION - ZONAL CAVITY METHOD

	80				70				50				30				10				0
	70	50	30	10	70	50	30	10	50	30	10	50	30	10	50	30	10	50	30	10	0
0	44	44	44	44	43	43	43	43	41	41	41	40	40	40	38	38	38	37	37	37	37
1	42	40	39	33	38	36	34	33	38	37	36	37	36	35	35	35	34	34	34	34	34
2	39	37	35	33	38	36	34	33	35	33	32	34	32	31	33	32	31	30	30	30	30
3	36	33	31	29	36	33	31	29	32	30	29	31	29	28	30	29	28	27	27	27	27
4	34	31	28	26	33	30	28	26	29	27	26	29	27	25	28	26	25	24	24	24	24
5	32	28	26	24	31	28	25	24	27	25	23	26	25	23	26	24	23	22	22	22	22
6	30	26	23	21	29	26	23	21	25	23	21	25	23	21	24	22	21	20	20	20	20
7	28	24	21	20	28	24	21	20	23	21	19	23	21	19	22	21	19	19	19	19	19
8	27	22	20	18	26	22	20	18	22	19	18	21	19	18	21	19	18	17	17	17	17
9	25	21	18	17	25	21	18	17	20	18	17	20	18	16	20	18	16	16	16	16	16
10	24	20	17	15	23	19	17	15	19	17	15	19	17	15	18	17	15	15	15	15	15

Catalog Number: ADS-159H-120H-FL
Lamp: Phosphor Coated Metal Halide

Reflector: Fabricated metal housing, brown painted flat metal panel behind lamp. Specular aluminum lower reflector, clear flat prismatic glass lens

Lumens: Per 1,000 lamp lumens

Efficiency: 37.2%

CIE Type: Direct

Luminaire Spacing Criteria: 1.1

Candela & Lumen values are based on 1,000 lamp lumens. For other lamp lumen ratings, multiply candela and lumen values by the number: Lumens divided by 1,000.

Per 1,000 Lamp Lumens

DEG	CANDELA	LUMENS
0	256.0	
5	260.0	25.0
15	257.0	72.0
25	213.0	96.0
35	129.0	80.0
45	65.0	49.0
55	30.0	27.0
65	14.0	14.0
75	7.0	8.0
85	1.0	2.0
90	0.0	

